

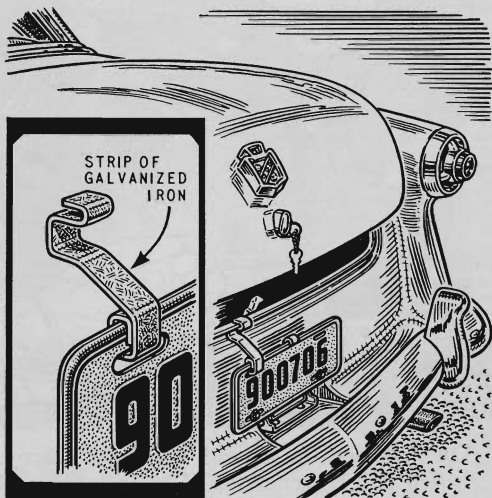

Hints FROM THE MODEL GARAGE



Stow a damp cloth in a plastic bag for cleaning dust and insects off your windshield between stops at service stations. Moisten the cloth with water or windshield cleaner and snap a rubber band around the neck of the bag to keep the fluid from evaporating.



To foil gas thieves, bend a length of galvanized strap iron to fit the top slot of the hinged license plate and the edge of the trunk opening. With this arrangement, a gas cap behind the license plate cannot be removed easily without unlocking the trunk.

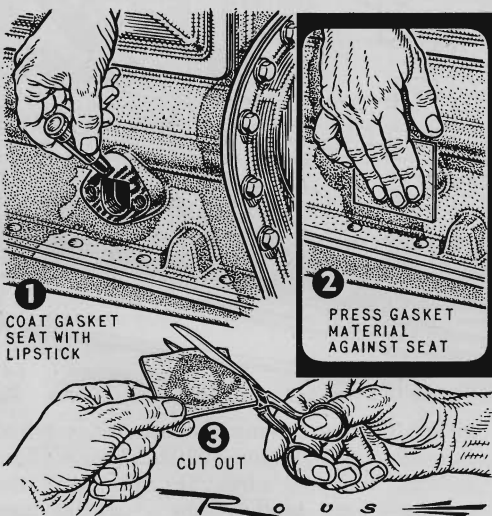

1
COAT GASKET SEAT WITH LIPSTICK

2
PRESS GASKET MATERIAL AGAINST SEAT

3
CUT OUT

Use lipstick to outline the shape of a flange on sheet material when cutting a gasket. Smear it over the entire surface and press the gasket material against it. The resulting imprint will show the outline as well as the hole locations.

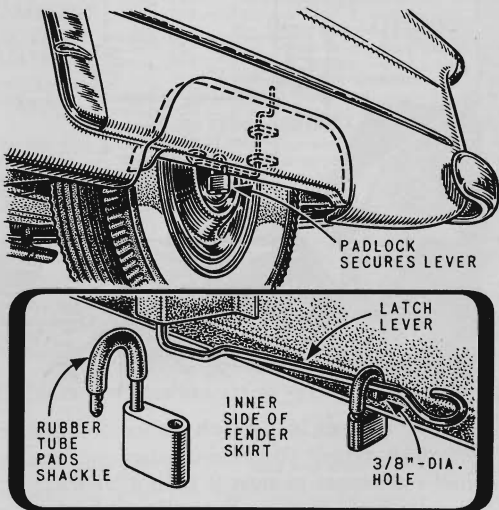

PADLOCK SECURES LEVER

LATCH LEVER

RUBBER TUBE PADS SHACKLE

INNER SIDE OF FENDER SKIRT

3/8"-DIA. HOLE

Thieves can't remove fender skirts if you fit them with padlocks to hold the clamping levers closed. Slip a lock over the lever arm and through a hole drilled in the bottom edge of each skirt. Cover the shackle with rubber tubing to keep it from rattling.

***MORE* Hints from the Model Garage**

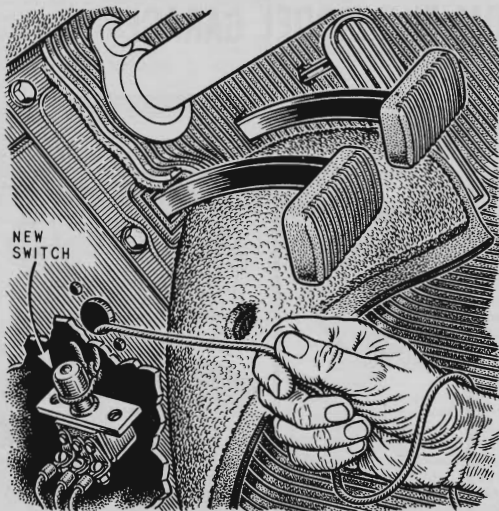

Tie a string to an old headlight dimmer switch before removing it to install a new one. This way you can pull the old one down by its wires and connect the wires to the new one. Tie the string on the new one and pull it up from inside the car.

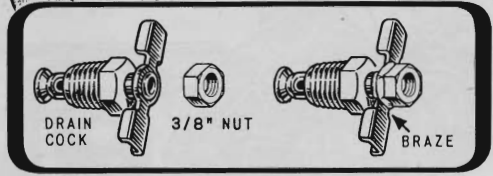
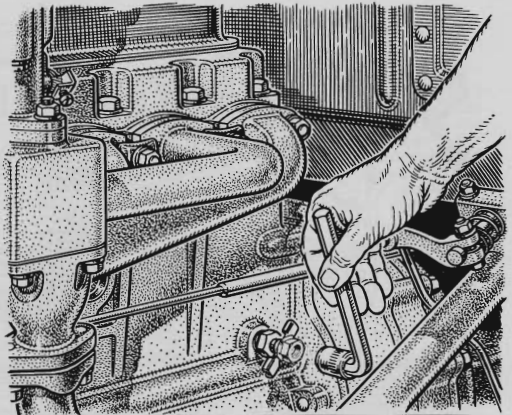

Braze a 3/8" nut on the T handle of your car's drain cocks to make them easier to turn. They are usually hard to reach, too, but a 12-point socket wrench will slip over the nut easily and open the drain in the tightest spaces. Water runs through the nut.

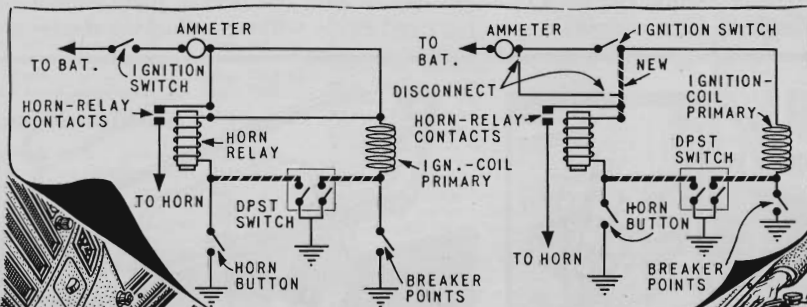

CLOSE ALARM SWITCH AND HORN WILL BLOW IF THIEF TRIES TO START CAR

Throw a toggle switch concealed under the dash when you leave your car, and a thief's attempts to start it with a trick key or by jumping a wire to the coil will be loudly announced by a steady blast of the horn. Even if he cuts the horn wire to work in silence, he won't start the engine; the breaker points are grounded and won't spark.

The diagram at left above shows how to wire a double-pole, single-throw toggle

switch on cars having the horn relay wired through the ignition switch. Heavy lines indicate the new wires. On other cars, the toggle wiring is the same, but the horn relay is disconnected from the ammeter or starter post and rewired to the ignition switch as in the diagram on the right. In either case, the horn cannot be sounded with the horn button unless the ignition switch is turned on.